

57F SERIES Centronic Connector IDC Type (flat cable)

Specifications/技术参数:

Electrical/电气特性:

Current Rating (额定电流): 3A
 Withstand Voltage (耐压值): 1000VAC for one minute
 Contact Resistance (接触电阻): 25mΩ max
 Insulation Resistance (绝缘电阻): 5000MΩ min
 Operating Temperature (工作温度): -40°C ~ +105°C

Physical/物理特性:

Insulator (塑胶本体): Glass Filled Polyester
 Flammability Rating (防火等级): UL 94V-0
 Contacts (接触件): Copper alloy
 Contacts plating (接触件电镀): Selective gold plating on surface contact area

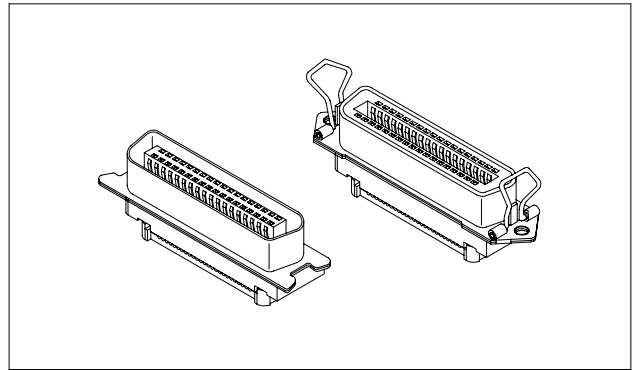

Dimension/尺寸: mm

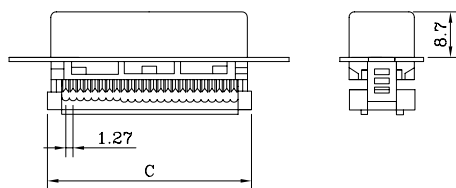
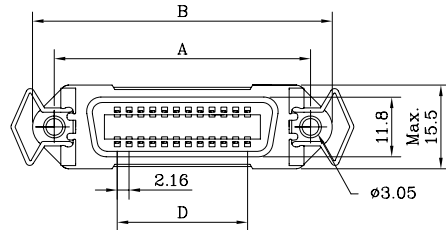
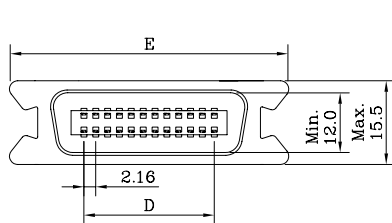

57F-30 系列

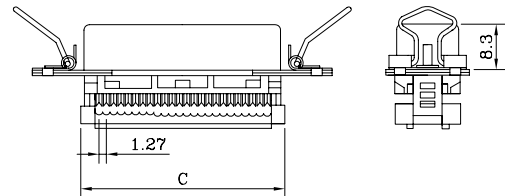

57F-40 系列

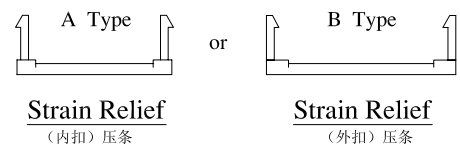
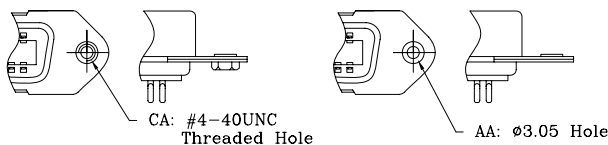

| Poles | Dim A | Dim B | DimC | Dim D | Dim E |
|-------|-------|-------|------|-------|-------|
| 24 | 46.8 | 54.7 | 35.5 | 23.76 | 48.6 |
| 36 | 59.7 | 67.7 | 53.3 | 36.72 | 61.6 |
| 50 | 74.9 | 82.8 | 68.5 | 51.84 | 76.7 |

Ordering Code/订购型号:

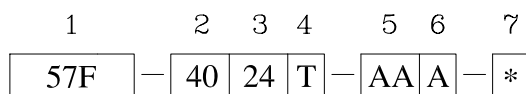

1. Series No./系列号:
57F

2. Contacts type/接触件类型:
30 = Male(公头)
40 = Female(母头)

3. Poles/位数:
24、36、50

4. Port Type/端口类型:
T = Traditional Type(传统式)
S = Simple Type(简易式)

5. Mounting options/安装选项:

AA = ø3.05mm Hole(光孔)
 CA = #4-40UNC Threaded Hole(螺纹孔)

6. Strain relief type/压条类型:

Default = W/O Strain relief
 A = Pin in (内扣型)
 B = Pin out (外扣型)

7. Insulator color/胶体颜色:

Default(缺省) = Blue(蓝色)
 3 = Black(黑色)