

# 8300 SERIES Mini Din Molding Type

## Specifications/技术参数:

### Electrical/电气特性:

Current Rating (额定电流): DC 30V, 1.0A max  
 Withstand Voltage (耐压值): AC 250V For 1minute  
 Contact Resistance (接触电阻): 30mΩ max  
 Insulation Resistance (绝缘电阻): 50MΩ min. at DC 250V  
 Operating Temperature (工作温度): -25°C ~ +70°C

### Physical/物理特性:

Insulator (塑胶本体): PBT +30% G.F  
 Flammability Rating (防火等级): UL 94V-0  
 Contacts (接触件): Copper Alloy, Gold Flash  
 Metal Shell (金属外壳): Copper Alloy, Nickel Plated



## Dimension/尺寸: mm

### Plug(插头公针):

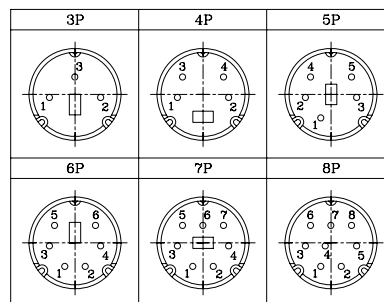
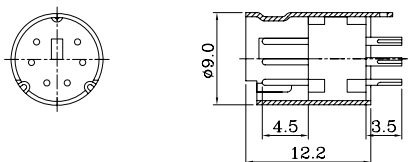

### Socket(插座母孔):

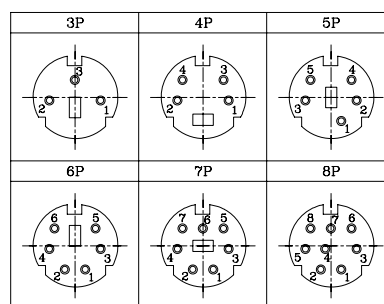
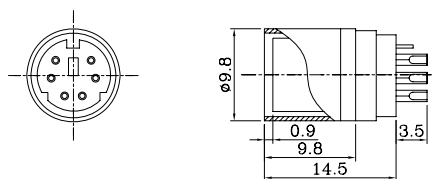

## Ordering Code/订购型号:

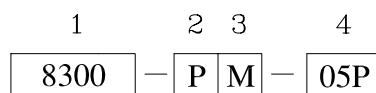

1. Series No./系列号: 8300

2. Contact type/接触件类型: P = Plug(插头公针)  
 S = Socket(插座母孔)
3. Housing type/壳体类型: M = Molding(注塑型)
4. Poles/位数: 3P, 4P, 5P, 6P, 7P, 8P